

How to Access an Isenberg Virtual Lab Computer

1. Open a browser on your computer. You can use a variety of browsers such as Chrome, Firefox, Safari or Edge.
2. In the address bar at the top of your screen, type the URL **desktop.isenberg.umass.edu** and then press enter.

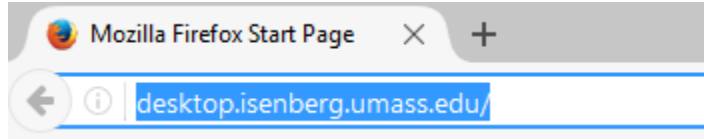

3. At the Isenberg login page, type your NetID and password in the Username and Password input sections. Use the credentials you use to login to Spire.
4. Click the **Login** button

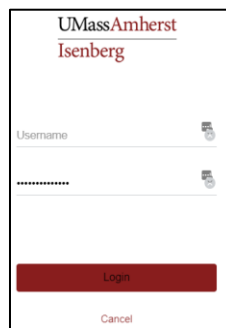

5. Click the **Virtual Computer Lab** icon and you will be redirected to the Windows welcome/setup dialog for a virtual lab computer.

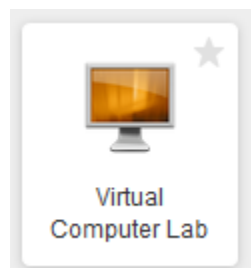

6. Be patient, it may take a few minutes to connect. Once you are presented with the Windows screen you can use all of the software found in the Isenberg on-campus computer labs.
7. Documents stored in your documents folder or desktop will be saved to your OneDrive folder. Access these documents on your personal computer by going to <http://onedrive.live.com>
8. At the end of your session, it is important to sign out of the Virtual Computer instead of simply closing your browser. If you don't sign out you may temporarily get locked out of the virtual computer pool.

- a. To sign out, click on the **Windows** icon on the virtual computer (the first of the two windows icons in the taskbars that appear at the bottom of your screen).



- b. Click on the **Person** icon

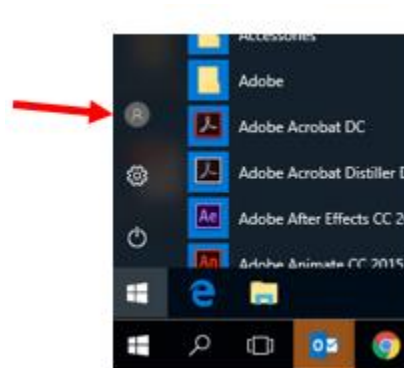

- c. Click **Sign Out**

